

FLOOD HAZARD INFORMATION

SEE FIS REPORT FOR DETAILED LEGEND AND INDEX MAP FOR FIRM PANEL LAYOUT
THE INFORMATION DEPICTED ON THIS MAP AND SUPPORTING DOCUMENTATION ARE ALSO AVAILABLE IN DIGITAL FORMAT AT [HTTPS://MSC.FEMA.GOV](https://MSC.FEMA.GOV)

	Without Base Flood Elevation (BFE) Zone A, V, A99 With BFE or Depth Zone AE, AO, AH, VE, AR
	Regulatory Floodway
	0.2% Annual Chance Flood Hazard, Areas of 1% annual chance flood with average depth less than one foot or with drainage areas of less than one square mile Zone X
	Future Conditions 1% Annual Chance Flood Hazard Zone X
	Area with Reduced Flood Risk due to Levee See Notes, Zone X
	Area with Flood Risk due to Levee Zone D
	NO SCREEN Areas of Minimal Flood Hazard Zone X
	Area of Undetermined Flood Hazard Zone D
	Channel, Culvert, or Storm Sewer
	Levee, Dike, or Floodwall
	18.2 17.5 Cross Sections with 1% Annual Chance Water Surface Elevation
	Coastal Transect
	Coastal Transect Baseline
	Profile Baseline
	Hydrographic Feature
	Base Flood Elevation Line (BFE)
	Limit of Study
	Jurisdiction Boundary

NOTES TO USERS

For information and questions about this Flood Insurance Rate Map (FIRM), available products associated with this FIRM, including historic versions, the current map date for each FIRM panel, how to order products, or the National Flood Insurance Program (NFIP) in general, please call the FEMA Map Information eXchange at 1-877-FEMA-MAP (1-877-336-2627) or visit the FEMA Flood Map Service Center website at <https://msc.fema.gov>. Available products may include previously issued Letters of Map Change, a Flood Insurance Study Report, and/or digital versions of this map. Many of these products can be ordered or obtained directly from the website.

Communities annexing land on adjacent FIRM panels must obtain a current copy of the adjacent panel as well as the current FIRM index. These may be ordered directly from the Flood Map Service Center at the number listed above.

For community and countywide map dates refer to the Flood Insurance Study Report for this jurisdiction.

To determine if flood insurance is available in this community, contact your insurance agent or call the National Flood Insurance Program at 1-800-638-6620.

Base Map information shown on this FIRM was provided in digital format by the U.S. Farm Service National Agriculture Imagery Program (NAIP), dated 2007, and by the U.S. Geological Survey Digital Orthophoto Quadrangles, dated 1993 or later, produced at a scale of 1:12000. The data was obtained from the United States Department of Agriculture (USDA).

SCALE

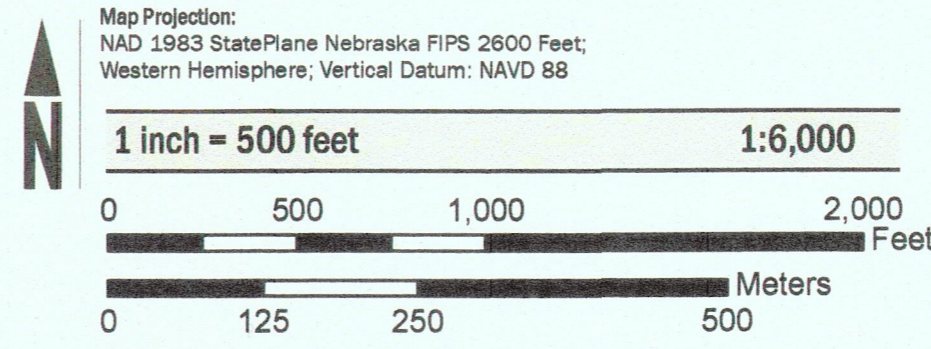

PANEL LOCATOR

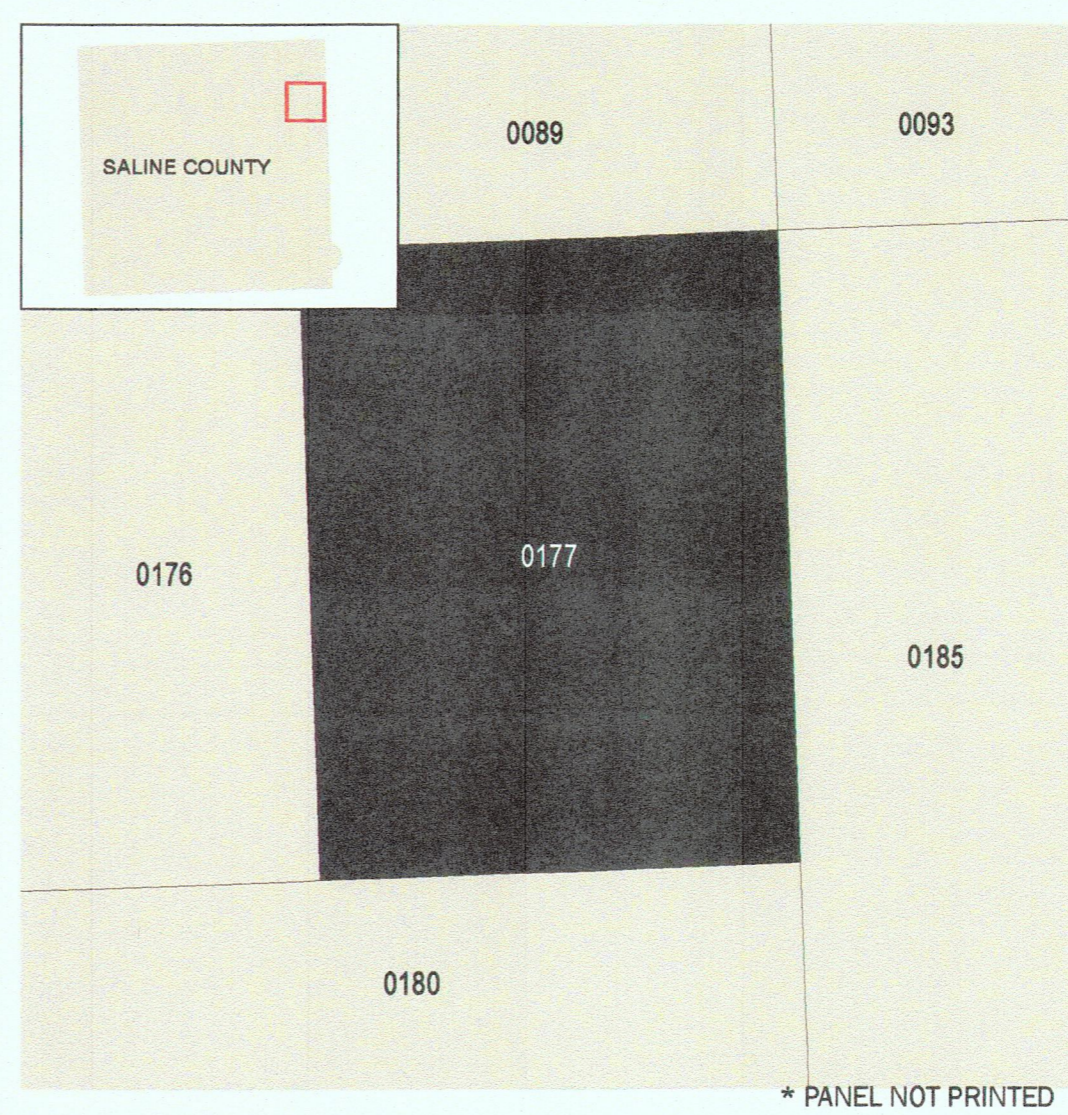

FEMA
 National Flood Insurance Program

**NATIONAL FLOOD INSURANCE PROGRAM
 FLOOD INSURANCE RATE MAP**

SALINE COUNTY, NEBRASKA
 and Incorporated Areas

PANEL 177 of 400

COMMUNITY	NUMBER	PANEL	SUFFIX
CITY OF CITY OF SALINE COUNTY	310186 310472	0177 0177	D D

Panel Contains:

**REVISED TO REFLECT LOMR
 EFFECTIVE: October 27, 2022**

VERSION NUMBER 2.1.3.0
 MAP NUMBER 31151C0177D
 EFFECTIVE DATE NOVEMBER 4, 2010