



2019 Gardener Application

Please fill out the requested information and mail it in or drop off at City Hall. Applications will be reviewed starting March 1 and plots will be assigned on a first come, first served basis. No plots will be assigned after June 1.

General Information: New gardener Returning gardener

Your name: _____

Names of others who may be working on your plot: _____

Your address: _____ City, state, zip code: _____

Phone number(s): _____ Email: _____

Preferred language: _____

Preferred method of contact: email text phone call
 mail in person

- Single garden plot size: 84 sf (7 ft x 12 ft). Multiple plots may be rented depending on demand.
- First plot is \$25 each, additional plots are \$20 each. See map for garden layout and to select your plots.
- Renters pay a one-time, \$20 deposit that is refundable in the fall after the plot is cleaned up. Deposit may be applied to the next year's rental fee. Deposit payment should be separate from plot cost.

Please indicate plot #(s) desired. (Availability depends on demand.)	Number of plots	Cost	Measurement in Square Feet	Total cost including deposit
	1	\$25.00	84 sf (7 ft x 12 ft)	\$45.00
	2	\$45.00	168 sf (7 ft x 24 ft)	\$65.00
	3	\$65.00	252 sf (7 ft x 36 ft)	\$85.00
	4	\$85.00	336 sf (7 ft x 48 ft)	\$105.00

Please pick up applications at:

- Crete Public Library, 305 East 13th Street
- City Hall Public Works Office, 243, East 13th Street
- Ace Hardware, Crete, 1025 Main Ave.
- Online - City of Crete website: www.crete.ne.gov

Completed applications and payments:

Drop-off: City Hall, 243 East 13th Street, Crete

Mail to: Crete Community Garden, P.O. Box 86, Crete, NE 68333

Please place the complete application in an envelope labeled "Crete Community Garden application." Cash or check (to "Crete Community Garden") accepted. Deposit (\$20) must be in cash.

If you have any questions or would like more information contact City Hall:

Jenn Lampila, 402.826.4312, jennifer.lampila@crete.ne.gov

For assistance in Spanish, please contact Nancy Tellez, 402.826.6405, nancy.tellez@crete.ne.gov

Online: www.crete.ne.gov or on Facebook: @CreteCommunityGarden or @CreteNE

Release of All Claims

I, _____, am a participant in the Crete Community Garden. As a condition of being allowed to participate in the Garden, I agree to the following:

1. I am duly aware of the risks and hazards that may arise through participation in the Crete Community Garden, and assume any expenses and liabilities I incur in the event of an accident, illness or other incapacity. If I have any questions about the Crete Community Garden, its nature, risks or hazards, I will contact the garden coordinator and discuss those questions or concerns with him/her to my satisfaction.

2. In consideration of being granted the opportunity to participate in the Crete Community Garden, I, for myself, my executors, administrators, agents and assigns do hereby release and forever discharge the Garden Coordinator, volunteers, other gardeners the cooperating landowner and the City of Crete from all claims of damages, demands, and any actions whatsoever, including those based on negligence, in any manner arising out of my participation in the activity. I understand that this Release means that, among other things, I am giving up my right to sue for any such losses, damages, injury or costs that I may incur.

I represent and certify that my true age is either 18 years old or older, or, if I am under 18 years old on this date, my parent or legal guardian has read and signed this form. I have read this entire Release, fully understand it, and I agree to be legally bound by it.

Participant's Signature _____

Printed Name _____ Date _____

Parent/Guardian's Signature (if participant is under age 18) _____

Printed Name _____ Date _____

GARDEN RULES

1. Assignment of garden plots will be awarded by a first come, first serve system. Preference for next year's plots will be given to the previous year's participants. No plot rentals will take place after June 1.
2. Plot fees are due in full before the garden season begins. Each gardener must complete a Release of all Claims form before any work in the garden can begin.
3. Each plot owner will receive the combination to the shed lock with their plot payment. Please lock the shed and return all tools and close garden gate when done working.
4. Each gardener is responsible for the maintenance and upkeep of their garden plot. Watering, weeding, harvesting and any other garden related maintenance are all the responsibility of the gardener. Gardeners may arrange for other gardeners to water their plots.
5. Garden plots should be cared for at least once a week. It is the gardener's responsibility to notify the coordinator if he or she is not able to care for their plot in any given week. If any plot remains unattended for more than three weeks, that plot is subject to reassignment.
6. The application of herbicides (weed killers) to the garden plots is prohibited.
7. Children are welcome in the garden but must be accompanied by an adult and must be supervised at all times.
8. At the end of the growing season, gardeners are responsible for clearing their plot of all plant material and leaving the plot as they found it in the spring. At that time, the deposit can be returned.
9. The Garden Planning and Management Committee is responsible for ensuring that rules are followed at all times.

CITY OF CRETE

Welcome to Crete, a vibrant "community on the move" that embraces our pioneering heritage and present-day diversity. Our hard-working community continues to thrive as we benefit from both a strong economy and a diverse population. This unity defines us. It moves us in the right direction and keeps us in motion.



City Hall

243 East 13th Street

Crete, NE 68333

PH: 402-826-4312

www.crete.ne.gov | @CreteNE



Crete residents looking for a space to grow their own garden can rent a plot for the season at the Crete Community Garden, located south of the intersection of 10th and Thornwood Ave. Tools and other amenities are available to all approved gardeners. Applications are available by March 1 each year.



@CreteCommunityGarden

www.crete.ne.gov | @CreteNE

GARDEN INFORMATION

Location: The garden is located south of the intersection of 10th Street and Thornwood Ave. in southwest Crete. The garden is fenced with an entrance gate and parking area. Amenities available to garden participants include a shed stocked with basic gardening tools, water hydrant, potting tables and benches, tomato/plant cages, and compost bins.

Plot Size & Cost: Individual garden plots typically measure 7 feet by 12 feet and are rented for the season at \$25 each. Gardeners may rent additional plots at \$20 each. A \$20 deposit per gardener is returned to those who abide by garden rules (see reverse) and participate in a fall clean up of their plots.

Applications: Gardening applications are made available by March 1 each year and plots are assigned on a first come, first served basis (using the numbered map at right). No plots will be assigned after June 1. Applications are available at City Hall - Public Works Office, Crete Public Library or on the city website - www.crete.ne.gov

Applications should be returned to City Hall or mailed to the Crete Community Garden, P.O. Box 86, Crete, NE 68333

Contact: The City of Crete and the Crete Community Garden both have Facebook Pages and garden information is also available on the city's website, by contacting City Hall or by sending an email:

jennifer.lampila@crete.ne.gov
nancy.tellez@crete.ne.gov

Crete Community Garden | 10th & Thornwood Ave.

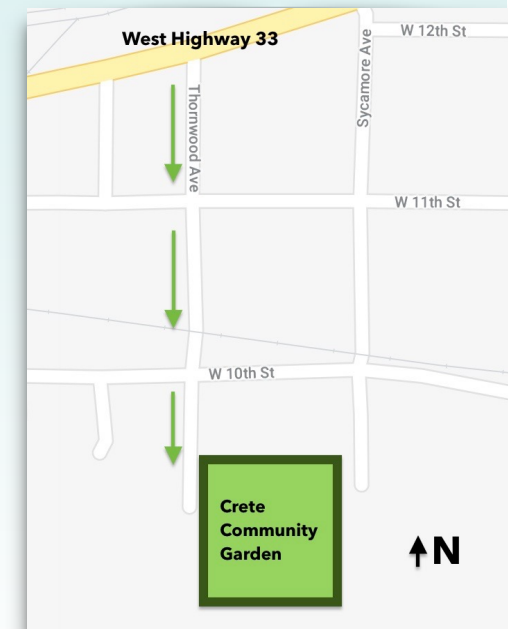
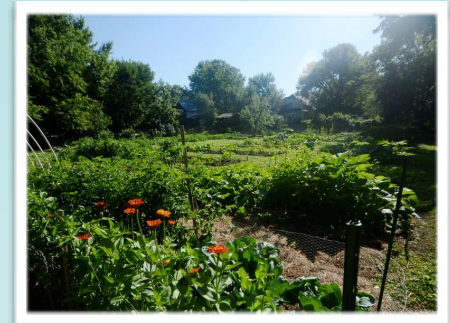
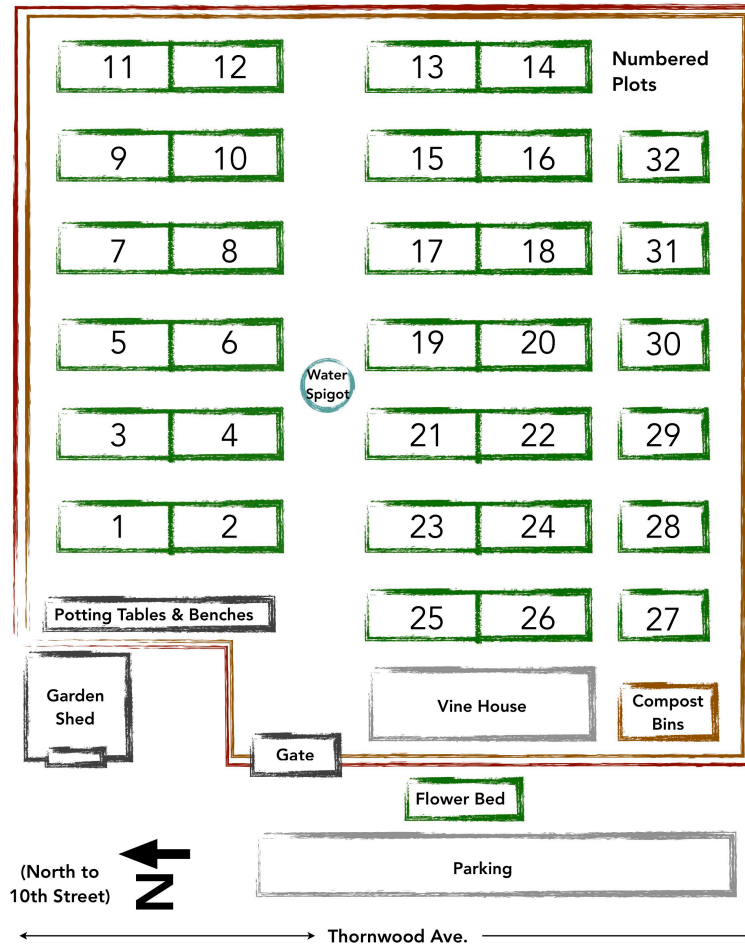

DATES TO REMEMBER

March 1: Applications available. Application review and plot assignments begin on a first-come, first-served basis.

May 1: Gardeners can begin planting (or earlier based on individual request). Some seeds may be available in the garden shed.

June 1: All plots assigned.

Nov. 30: All plants removed and plots cleaned; deposits returned contingent on clean-up.



@CreteCommunityGarden | @CreteNE | www.crete.ne.gov